

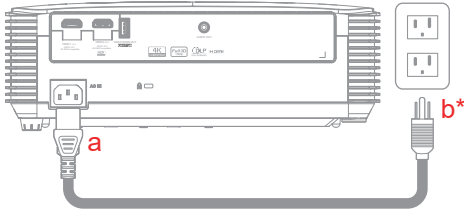

For access to the setup information, user manual, and product updates – please scan the QR Code or visit the following URL:  
<https://www.optoma.com/support/download>

1



2

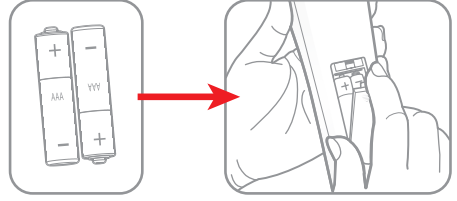

3

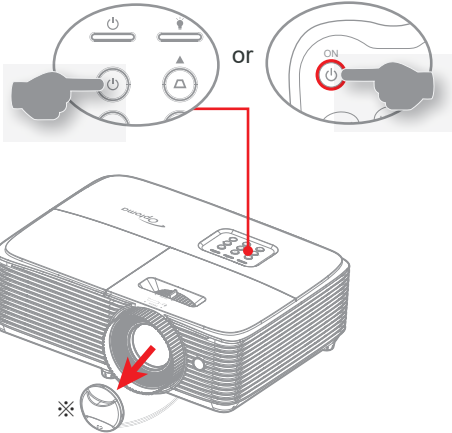

4

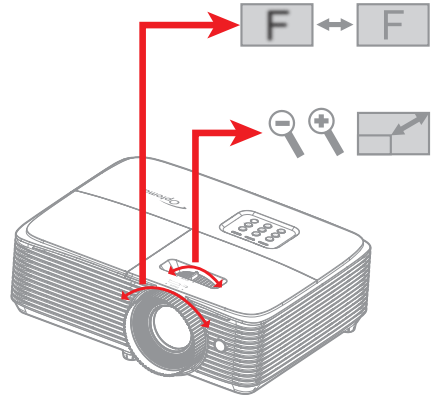

5\*

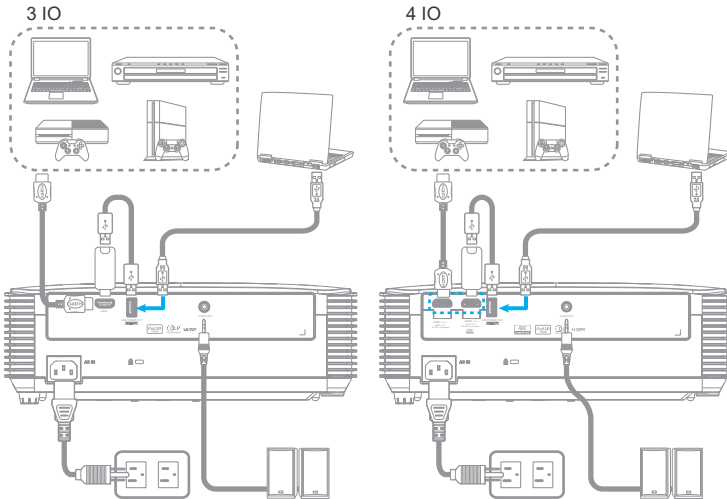

6\*

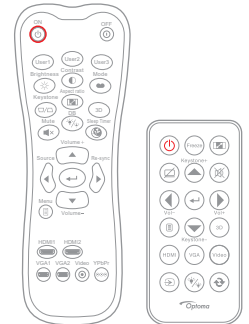

- Note:**
- To prolong the effective life of the lamp, make sure to keep the lamp on for at least 60 seconds and avoid performing force shutdown.
  - The lens cap, the number of IO ports, and the remote control may vary depending on the region or model. \*
  - For warranty information, please visit our website: [www.optoma.com](http://www.optoma.com)
  - For detailed instructions, please scan the QR code or visit the URL: <https://www.optoma.com/support/download>





