

CONTROLS ON RIGHT

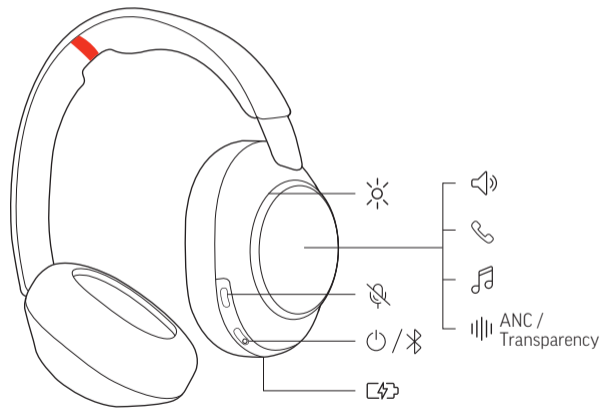

TOUCH CONTROLS ON RIGHT

Tap/Press

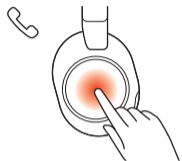

- Tap to answer
- Press to end

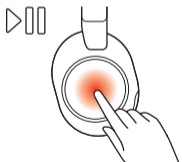

- Tap to play/pause

Swipe

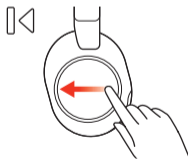
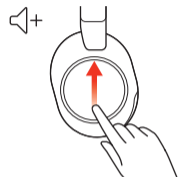
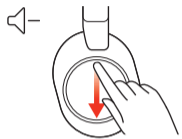

 poly.com/support

PAIR TO MOBILE PHONE

1.

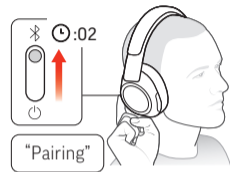

2.

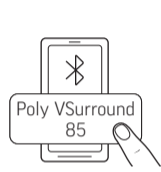

3.



CONNECT TO COMPUTER

1.

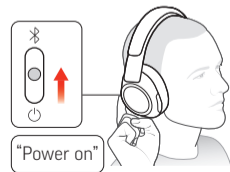

2.

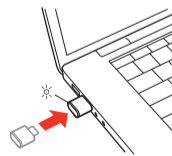

3.



CUSTOMIZE YOUR HEADSET

Configure custom button in Poly Lens App. Choose from ANC/Transparency mode (default), Check device status and more.

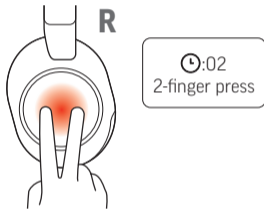

DOWNLOAD APP

Download Poly Lens App to get the most out of your headset.

- Configure custom button feature
- Change settings
- Update devices
- View user guide

↓ poly.com/lens

Poly Lens Mobile App
Poly Lens Desktop App

WEAR HEADSET

Microphones are on the front of your earcups. For best call audio, ensure your headset is worn correctly.



CHARGE

Place the headset on the charge stand. Charge stand LED is solid when charging and turns off when the headset is fully charged. Charge stand plugs into a computer or wall charger's USB-C port.

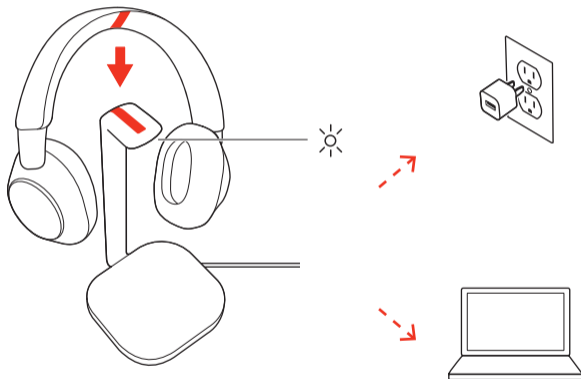

©2023 Poly. Bluetooth is a registered trademark of Bluetooth SIG, Inc. All trademarks are the property of their respective owners.
RMN (모델명/型号/型號): VS85T, CBVS1, BT700, BT700C
211720-12 06.23



Recyclable where facilities exist



QUICK START

VOYAGER SURROUND 85 UC
WITH POLY WIRELESS CHARGE STAND

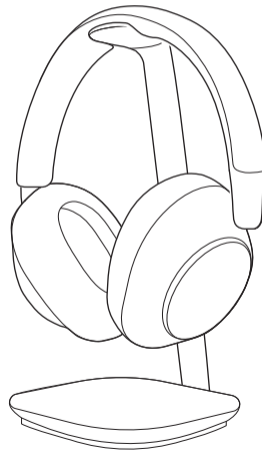

Located in case.
BT700 adapter design varies.